

INSTALLATION MANUAL

DUO POWER HALOGEN WORK LAMP



Duo Power Halogen Work Lamp
FLOOD---MODEL # = DBWL222FL
SPOT-----MODEL # = DBWL222SP
6.5"High X 6.9"Wide X 3.3"Deep
(2) 55 Watt H3 Halogen Lamps
Operating Voltage : 12V
Wide Angle Lens

PSE AMBER
from **CODE 3**

www.code3pse.com

Tech Support: (314) 996-2800

WIRING:

1. WIRE GAUGE: USE MINIMUM 14 GAUGE WIRE & CONNECTORS
2. CONNECT RED (+) WIRE TO POSITIVE OR POWER.
CONNECT BLACK (-) WIRE TO NEGATIVE OR GROUND.
3. FUSE REQUIREMENTS: 15AMP FUSE.
4. WEATHER RESISTANT CONNECTORS RECOMMENDED.



Adjustable 360 Degrees
Horizontally

HAT BRACKET

MOUNTING:

TO MOUNT WITHOUT HAT BRACKET
DRILL (1) 13/32" DIA HOLE
AT DESIRED LOCATION.

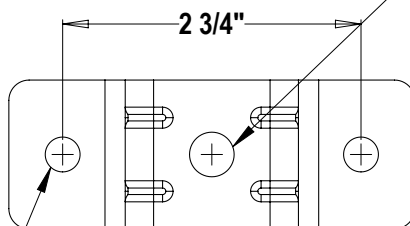

TO MOUNT WITH HAT BRACKET
DRILL (2) 21/64" DIA HOLES
AT DESIRED LOCATION.



Adjustable 180 Degrees
Vertically

Code 3 is a registered trademark of Code 3, Inc.
a subsidiary of Public Safety Equipment, Inc.

Code 3®, Inc.
10986 N. Warson Road
St. Louis, Missouri 63114-2029—USA
Ph. (314) 426-2700 Fax (314) 426-1337

www.code3pse.com

Revision 0, 09/11 - Instruction Book Part No. T15477
©2011 Public Safety Equipment, Inc. Printed in USA