

INSTALLATION & OWNERS MANUAL

REMOTE CONTROLLED SPOTLIGHT



Code 3, Inc., a subsidiary of
Public Safety Equipment, Inc.

CODE 3[®]
PUBLIC SAFETY EQUIPMENT, INC.

NIGHTPROBE[®] IN LIGHTBAR

Introduction

The NightProbe , NP 130, product can be mounted in the center section of a Code 360, Excalibur or MX lightbar. This offers the user an unobstructed 360 degrees of light around the vehicle.

Installation & Mounting

1. Install the circular gasket on the upper surface of the lens cover and spacer.
2. Route the cables from the bottom of the spotlight through the gasket, lens cover as shown in Figure 2.
3. Place the other two spacers on the lens cover. They will be sandwiched between the lens cover and the mounting plate.
4. Place the mounting plate over the spacers, align the holes in the mounting plate with the holes in the lens cover.
5. Attach the spotlight with four #6x3/4" screws to the mounting plate.
6. Remove the center lens of the lightbar and keep the four lens clips for reuse.
7. Route the cables through the existing hole in the bottom of the lightbar, insure that there is adequate length to reach the area in which the controller is to be mounted.
8. Install the spotlight mounting bracket to the lightbar frame using eight #8 x .270" screws. The bracket should fit snugly between the plastic ribs of the lower lens to ensure alignment with the lens/mtg plate assy.
9. Install the spotlight and lens/mtg plate to the lower lens being careful not to pinch the cables. Fasten with four #14 x 3/4" washer seal screws.
10. Reinstall the four lens clips.
11. Connect the wiring and the control box per instructions with the spotlight.

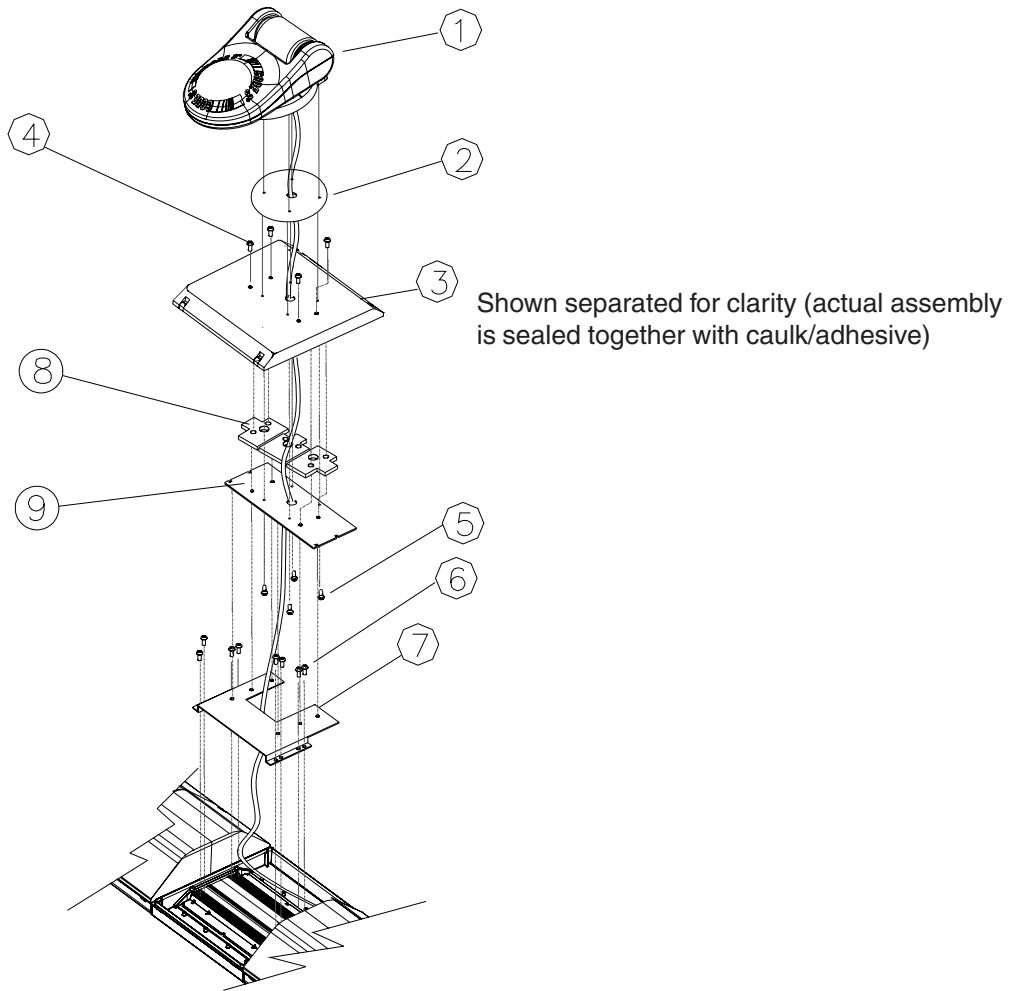

Figure 2

Parts List

<u>Ref No.</u>	<u>Description</u>	<u>Part No.</u>	<u>Qty.</u>
1	Spotlight -Complete	S50597	01
2	Gasket, .062 thk foam, RE41E black	T05084	01
3	Cover	S96255	01
4	Fastener #14x3/4 with washer seal	T05070	06
5	Fastener #6x3/4	T01031	04
6	Fastener #8x.270	T01215	08
7	Spotlight mounting bracket (Code 360/Excalibur)	S50795	01
	MX	S50593	01
8	Spacer, Spotlight in lightbar	S96254	03
9	Mounting Plate	S50796	01



The use of this or any warning device does not ensure that all drivers can or will observe or react to an emergency warning signal. Never take the right-of-way for granted. It is your responsibility to be sure you can proceed safely before entering an intersection, driving against traffic, responding at a high rate of speed, or walking on or around traffic lanes. The effectiveness of this warning device is highly dependent upon correct mounting and wiring. Read and follow the manufacturer's instructions before installing or using this device. The vehicle operator should insure daily that all features of the device operate correctly. In use, the vehicle operator should insure the projection of the warning signal is not blocked by vehicle components (i.e.: open trunks or compartment doors), people, vehicles, or other obstructions.

This equipment is intended for use by authorized personnel only. It is the user's responsibility to understand and obey all laws regarding emergency warning devices. The user should check all applicable city, state and federal laws and regulations.

Public Safety Equipment, Inc., assumes no liability for any loss resulting from the use of this warning device.

Proper installation is vital to the performance of this warning device and the safe operation of the emergency vehicle. It is important to recognize that the operator of the emergency vehicle is under psychological and physiological stress caused by the emergency situation. The warning device should be installed in such a manner as to: A) Not reduce the output performance of the system, B) Place the controls within convenient reach of the operator so that he can operate the system without losing eye contact with the roadway.

Emergency warning devices often require high electrical voltages and/or currents. Properly protect and use caution around live electrical connections. Grounding or shorting of electrical connections can cause high current arcing, which can cause personal injury and/or severe vehicle damage, including fire.

PROPER INSTALLATION COMBINED WITH OPERATOR TRAINING IN THE PROPER USE OF EMERGENCY WARNING DEVICES IS ESSENTIAL TO INSURE THE SAFETY OF EMERGENCY PERSONNEL AND THE PUBLIC.

Notes:

WARRANTY

Code 3, Inc. emergency devices are tested and found to be operational at the time of manufacture. Provided they are installed and operated in accordance with manufacturer's recommendations, Code 3, Inc. guarantees all parts and components except the lamps to a period of 1 year (unless otherwise expressed) from the date of purchase or delivery, whichever is later. Units demonstrated to be defective within the warranty period will be repaired or replaced at the factory service center at no cost.

Use of lamp or other electrical load of a wattage higher than installed or recommended by the factory, or use of inappropriate or inadequate wiring or circuit protection causes this warranty to become void. Failure or destruction of the product resulting from abuse or unusual use and/or accidents is not covered by this warranty. Code 3, Inc. shall in no way be liable for other damages including consequential, indirect or special damages whether loss is due to negligence or breach of warranty.

CODE 3, INC. MAKES NO OTHER EXPRESS OR IMPLIED WARRANTY INCLUDING, WITHOUT LIMITATION, WARRANTIES OF FITNESS OR MERCHANTABILITY, WITH RESPECT TO THIS PRODUCT.

PRODUCT RETURNS

If a product must be returned for repair or replacement*, please contact our factory to obtain a Return Goods Authorization Number (RGA number) before you ship the product to Code 3. Write the RGA number clearly on the package near the mailing label. Be sure you use sufficient packing materials to avoid damage to the product being returned while in transit.

*Code 3, Inc. reserves the right to repair or replace at its discretion. Code 3, Inc. assumes no responsibility or liability for expenses incurred for the removal and /or reinstallation of products requiring service and/or repair.; nor for the packaging, handling, and shipping; nor for the handling of products return to sender after the service has been rendered.

NEED HELP? Call our Technical Assistance Hotline - (314) 996-2800

Code 3,® Inc., a subsidiary of
Public Safety Equipment, Inc.

CODE 3[®]
PUBLIC SAFETY EQUIPMENT, INC.

Code 3, Inc.
10986 N. Warson Road
St. Louis, Missouri 63114-2029—USA
www.code3pse.com

Revision 2, 03/2006 - Instruction Book Part No. T05083
©2002-6 Code 3, Inc. Printed in USA

NightProbe and Code 3 are registered trademarks of Code 3, Inc. a subsidiary of Public Safety Equipment, Inc.